



HEINZ

PRODUCT SPECIFICATION SHEET

PRODUCT: GFS CREAM OF BROCCOLI

VARIETY NUMBER: 131060

PACKAGE SIZE: 4 – 8 LB BAGS PER CASE

PRODUCT DESCRIPTION: A SOUP CONTAINING PIECES OF CUT AND CHOPPED BROCCOLI. THE MEDIUM-BODIED BROTH HAS A MILD BROCCOLI AND CHEESE FLAVOR IN A RICH CREAMY DAIRY BACKGROUND.

READY TO COOK

PREPARATION INSTRUCTIONS:

Boil-in-Bag:

1. CAREFULLY PLACE UNOPENED BAG OF PRODUCT IN BOILING WATER.
2. COOK UNTIL CONTENTS REACH 185°F.
3. CHECK TEMPERATURE BY REMOVING BAG FROM WATER; FOLD THE UNOPENED BAG AROUND A STEMMED THERMOMETER.
4. TRANSFER COOKED PRODUCT TO HOLDING OR SERVING CONTAINER:
 - a. FOR EASIER HANDLING, INSERT POUCH INTO LARGE PITCHER.
 - b. CUT OPEN CORNER OF POUCH OPPOSITE PITCHER HANDLE.
5. CAREFULLY POUR INTO SERVING CONTAINER; HOLD & SERVE AT GREATER THAN 150°F.

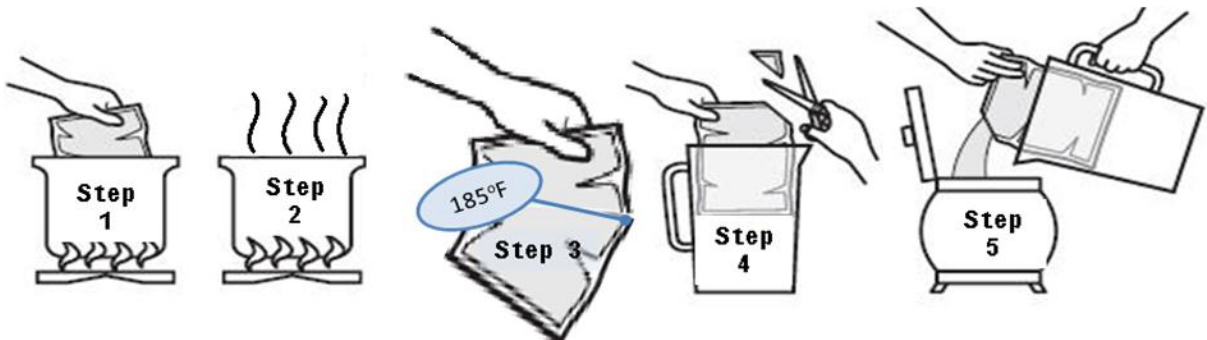

FOLLOW THE FDA FOOD CODE FOR HANDLING LEFTOVERS.

ANALYTICAL DATA: Available Upon Request

MICROBIOLOGICAL DATA: Available Upon Request



CONTAINER PACKAGING:

Container: 8 lb Bag

CONTAINER CODING: Primary Packaging

PP YM DD BBBB TT:TT (Explanation below)

CASE PACKAGING:

Pack/Size: 4/8 lb
Case Net Wt: 32.0 lbs
Case Gross Wt: 33 lbs
Case Cube: 0.74 cu. ft.
Case Size (OD): 14.438" x 8.625" x 10.25"
Cases/Pallet: 65
Cases/Layer: 13
Layers/Pallet: 5

CASE CODING: Secondary Packaging

Example: PP YM DD TT:TT (Explanation Below)

CODE DESIGNATION

Each case and unit is labeled with a code designation which includes plant location, date of production, batch number and production line.

PPYMDD TT:TT

- | | |
|--------------------------------------|------------------------------------|
| <u>P - Plant code</u> - | LD = Cedar Rapids |
| <u>Y - Year</u> - | 1 digit (last digit of year) |
| <u>M - Month</u> - | 1 alpha (see month code key below) |
| <u>D - Day of Month</u> - | 2 digits |
| <u>B - Batch Identifier</u> - | 3 digits and 1 alpha |
| <u>T - Military Time</u> - | 4 digits w/ colon |

Example: For product packed at Cedar Rapids on 07/27/2011 at 2:30 PM would read:

LD 1G27 14:30

Month Code Key (Note: the letter "I" is not used)

- | | |
|--------------|---------------|
| A = January | G = July |
| B = February | H = August |
| C = March | J = September |
| D = April | K = October |
| E = May | L = November |
| F = June | M = December |

MANUFACTURING LOCATION: CEDAR RAPIDS, IOWA, P15818A, M15818A

STORAGE: Keep frozen at or below 0°F

DISTRIBUTION: Keep frozen

SHELF LIFE: 365 days



INGREDIENT STATEMENT:

WATER, MILK, BROCCOLI, HEAVY CREAM, PASTEURIZED PROCESS AMERICAN CHEESE (AMERICAN CHEESE [MILK, CHEESE CULTURES, SALT, ENZYMES], WATER, SODIUM PHOSPHATE, CREAM, SALT, SORBIC ACID, OLEORESIN PAPRIKA), BROCCOLI PUREE, WHEY POWDER (MILK), MODIFIED CORNSTARCH, CONTAINS 2% OR LESS OF: SALT, VEGETABLE SHORTENING (PARTIALLY HYDROGENATED SOYBEAN OIL, PARTIALLY HYDROGENATED COTTONSEED OIL, MONO- AND DIGLYCERIDES, POLYSORBATE 60), COOKED MECHANICALLY SEPARATED CHICKEN, SUGAR, SPICE, YEAST EXTRACT (SOY), FLAVOR ENHANCER (HYDROLYZED CORN GLUTEN, WHEAT AND SOY PROTEIN, AUTOLYZED YEAST EXTRACT), SODIUM STEAROYL LACTYLATE, EMULSIFIER (PROPYLENE GLYCOL MONOSTEARATE, MONOGLYCERIDES), CULTURED SKIM MILK POWDER, GARLIC SALT (SALT, GARLIC), TURMERIC.

CONTAINS: MILK, WHEAT, SOY

NUTRITIONAL DATA:

Per Serving:

Nutrition Facts	
Serving Size 1 cup (245g)	
Servings Per Container About 59	
Amount Per Serving	
Calories 200	Calories from Fat 110
% Daily Value*	
Total Fat 12g	19%
Saturated Fat 6g	30%
Trans Fat 0g	
Cholesterol 40mg	14%
Sodium 1040mg	43%
Total Carbohydrate 16g	5%
Dietary Fiber 1g	5%
Sugars 10g	
Protein 7g	
Vitamin A 25%	• Vitamin C 35%
Calcium 15%	• Iron 2%
*Percent Daily Values are based on a 2,000 calorie diet. Your daily values may be higher or lower depending on your calorie needs.	
	Calories: 2,000 2,500
Total Fat	Less than 65g 80g
Saturated Fat	Less than 20g 25g
Cholesterol	Less than 300mg 300mg
Sodium	Less than 2,400mg 2,400mg
Total Carbohydrate	300g 375g
Dietary Fiber	25g 30g
Calories per gram:	
Fat 9 • Carbohydrate 4 • Protein 4	

Per 100 gram:

Nutrient	per 100g
Calories	81.24
Calories from Fat	45.64
Protein	2.77g
Carbohydrates	6.57g
Dietary Fiber	0.54g
Sugar - Total	4.19g
Fat - Total	5.07g
Saturated Fat	2.48g
Trans Fatty Acids	0.16g
Cholesterol	17.32mg
Water	84.02g
Ash	1.55g
Vitamin A	460.23 IU
Vitamin C	8.08mg
Calcium	36mg
Iron	0.18mg
Potassium	144.71mg
Sodium	425.23mg