



HEINZ

PRODUCT SPECIFICATION SHEET

PRODUCT: GORDON FOOD SERVICE CHICKEN AND DUMPLINGS

VARIETY NUMBER: 625200

PACKAGE SIZE: 4 – 8LB BAGS PER CASE

PRODUCT DESCRIPTION: A soup containing spaetzle dumplings, chunks of chicken with carrots, celery and onions in a rich, moderately thick broth.

READY TO COOK

PREPARATION INSTRUCTIONS:

Boil-in-Bag:

1. CAREFULLY PLACE UNOPENED BAG OF PRODUCT IN BOILING WATER.
2. COOK UNTIL CONTENTS REACH 185°F.
3. CHECK TEMPERATURE BY REMOVING BAG FROM WATER; FOLD THE UNOPENED BAG AROUND A STEMMED THERMOMETER.
4. TRANSFER COOKED PRODUCT TO HOLDING OR SERVING CONTAINER:
 - a. FOR EASIER HANDLING, INSERT POUCH INTO LARGE PITCHER.
 - b. CUT OPEN CORNER OF POUCH OPPOSITE PITCHER HANDLE.
5. CAREFULLY POUR INTO SERVING CONTAINER; HOLD & SERVE AT GREATER THAN 150°F.

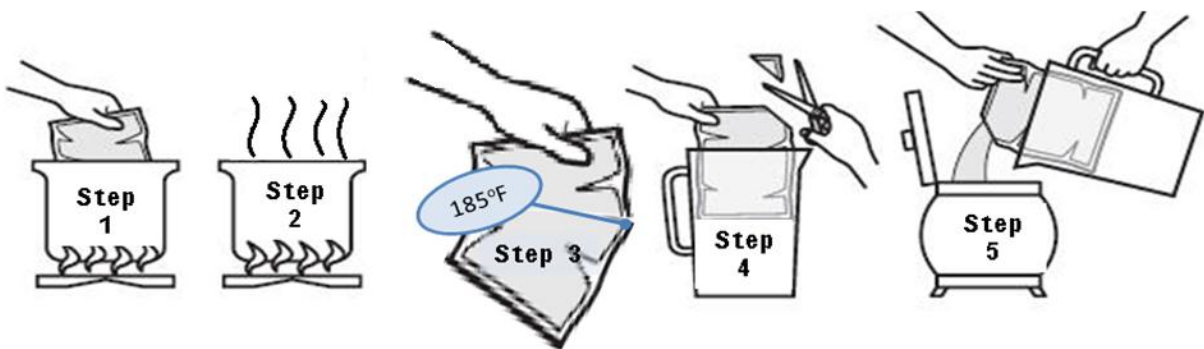

FOLLOW THE FDA FOOD CODE FOR HANDLING LEFTOVERS.

ANALYTICAL DATA: Available Upon Request

MICROBIOLOGICAL DATA: Available Upon Request



CONTAINER PACKAGING:

Container: 8 lb Bag

CONTAINER CODING: Primary Packaging

PP YM DD BBBB TT:TT (Explanation below)

CASE PACKAGING:

Pack/Size: 4/8 lb
Case Net Wt: 32
Case Gross Wt: 33.00 lbs
Case Cube: 0.74
Case Size (OD): 14.438" x 8.625" x 10.25"
Cases/Pallet: 65
Cases/Layer: 13
Layers/Pallet: 5

CASE CODING: Secondary Packaging

Example: PP YM DD TT:TT (Explanation Below)

CODE DESIGNATION

Each case and unit is labeled with a code designation which includes plant location, date of production, batch number and production line.

PPYMDD TT:TT

- P - Plant code** - LD = Cedar Rapids
- Y - Year** - 1 digit (last digit of year)
- M - Month** - 1 alpha (see month code key below)
- D - Day of Month** - 2 digits
- B - Batch Identifier** - 3 digits and 1 alpha
- T - Military Time** - 4 digits w/ colon

Example: For product packed at Cedar Rapids on 07/27/2013 at 2:30 PM would read:

LD 3G27 14:30

Month Code Key (Note: the letter "I" is not used)

- | | |
|--------------|---------------|
| A = January | G = July |
| B = February | H = August |
| C = March | J = September |
| D = April | K = October |
| E = May | L = November |
| F = June | M = December |

MANUFACTURING LOCATION: CEDAR RAPIDS, IOWA, P15818A, M15818A

STORAGE: Keep frozen at or below 0°F

DISTRIBUTION: Keep frozen

SHELF LIFE: 720 days



INGREDIENT STATEMENT:

WATER, SPAETZLE DUMPLINGS (WATER, ENRICHED FLOUR [WHEAT FLOUR MALTED BARLEY FLOUR, NIACIN, FERROUS SULFATE, THIAMINE MONONITRATE, RIBOFLAVIN, FOLIC ACID], EGGS, ENRICHED DURUM FLOUR [DURUM WHEAT FLOUR, NIACIN, FERROUS SULFATE, THIAMINE MONONITRATE, RIBOFLAVIN, FOLIC ACID], SALT, WHEAT GLUTEN, OLEORESIN TURMERIC), CELERY, COOKED CHICKEN MEAT (WHITE MEAT CHICKEN, DARK MEAT CHICKEN, WATER, MODIFIED POTATO STARCH, SALT, SODIUM PHOSPHATE, CARRAGEENAN), ONIONS, CARROTS, MODIFIED CORNSTARCH, CONTAINS 2% OR LESS OF: NONFAT DRY MILK, SALT, COOKED CHICKEN MEAT, HYDROLYZED CORN PROTEIN, SUGAR, RENDERED CHICKEN FAT (CHICKEN FAT, FLAVORING), CHICKEN BROTH, WHEY POWDER (MILK), BUTTER FLAVOR (WHEY SOLIDS, ENZYME MODIFIED BUTTER, MALTODEXTRIN, SALT, DEHYDRATED BUTTER, GUAR GUM, ANNATTO AND TURMERIC), ONION POWDER, DISODIUM INOSINATE AND DISODIUM GUANYLATE, TURMERIC, PARSLEY.

ALLERGENS: EGGS, MILK, WHEAT

NUTRITIONAL DATA:

Per Serving

Per 100 gram

Nutrition Facts	
Serving Size 1 cup (245g)	
Servings Per Container About 59	
Amount Per Serving	
Calories 130	Calories from Fat 20
% Daily Value*	
Total Fat 2.5g	4%
Saturated Fat 0.5g	3%
Trans Fat 0g	
Cholesterol 30mg	10%
Sodium 950mg	40%
Total Carbohydrate 19g	6%
Dietary Fiber 1g	4%
Sugars 4g	
Protein 7g	
Vitamin A 10%	• Vitamin C 4%
Calcium 8%	• Iron 4%
*Percent Daily Values are based on a 2,000 calorie diet. Your daily values may be higher or lower depending on your calorie needs:	
	Calories 2,000 2,500
Total Fat	Less than 65g 80g
Saturated Fat	Less than 20g 25g
Cholesterol	Less than 300mg 300 mg
Sodium	Less than 2,400mg 2,400mg
Total Carbohydrate	300g 375g
Dietary Fiber	25g 30g
Calories per gram:	
Fat 9 • Carbohydrate 4 • Protein 4	

Nutrient	Amount Per 100g	
Calories	51.87	kcal
Calories from Fat	8.46	kcal
Total Fat	0.94	g
Saturated Fat	0.26	g
Trans Fat	0.00	g
Ash	1.50	g
Cholesterol	12.81	mg
Sodium	388.92	mg
Potassium	185.80	mg
Total Carbohydrate	7.80	g
Dietary Fiber	0.48	g
Sugars	1.47	g
Protein	2.87	g
Vitamin A	220.96	IU
Vitamin C	0.79	mg
Calcium	33.76	mg
Iron	0.30	mg

NATIONAL SCHOOL LUNCH PROGRAM CHILD NUTRITION MEAL CREDITS: ½ CUP OTHER VEGETABLE