



HEINZ

PRODUCT SPECIFICATION SHEET

PRODUCT: GFS CHICKEN NOODLE SOUP

VARIETY NUMBER: 131100

PACKAGE SIZE: 4-8 LB BAGS PER CASE

PRODUCT DESCRIPTION: Old fashioned thick egg noodles and pieces of moist chicken are cooked in a light broth with carrots and celery in our version of the classic soup that makes you fall in love with it all over again.

PREPARATION INSTRUCTIONS*:

Boil-in-Bag:

1. CAREFULLY PLACE UNOPENED BAG OF PRODUCT IN BOILING WATER.
2. COOK UNTIL CONTENTS REACH 185°F.
3. CHECK TEMPERATURE BY REMOVING BAG FROM WATER; FOLD THE UNOPENED BAG AROUND A STEMMED THERMOMETER.
4. TRANSFER COOKED PRODUCT TO HOLDING OR SERVING CONTAINER:
 - a. FOR EASIER HANDLING, INSERT POUCH INTO LARGE PITCHER.
 - b. CUT OPEN CORNER OF POUCH OPPOSITE PITCHER HANDLE.
5. CAREFULLY POUR INTO SERVING CONTAINER; HOLD & SERVE AT GREATER THAN 150°F.

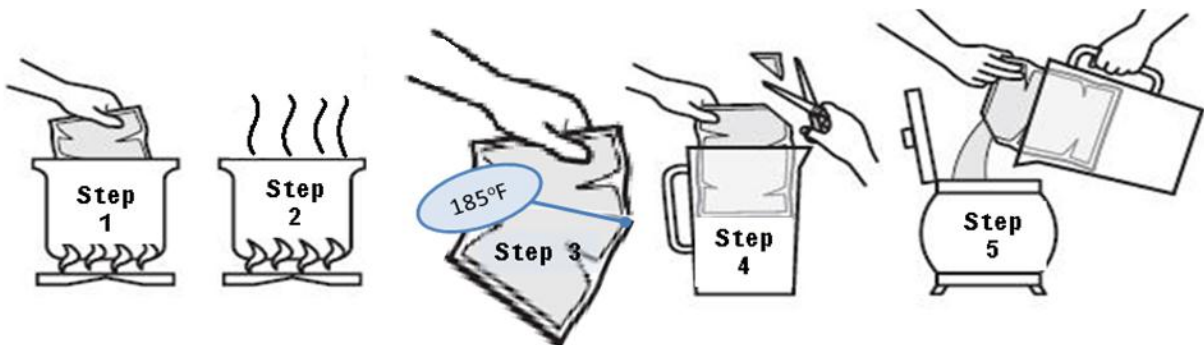

FOLLOW THE FDA FOOD CODE FOR HANDLING LEFTOVERS.

ANALYTICAL DATA:

Available Upon Request

MICROBIOLOGICAL DATA:

Available Upon Request



CONTAINER PACKAGING:

Container: 8 lb Bag

CONTAINER CODING: Primary Packaging

PP YM DD BBBB TT:TT (Explanation below)

CASE PACKAGING:

Pack/Size: 4/8 lbs.
Case Net Wt: 32 lbs.
Case Gross Wt: 33.05 lbs.
Case Cube: 0.88 cu ft.
Case Size (OD): 16" x 13.313" x 7.125"
Cases/Pallet: 63
Cases/Layer: 9
Layers/Pallet: 7 :

CASE CODING: Secondary Packaging

Example: PP YM DD TT:TT (Explanation Below)

CODE DESIGNATION

Each case and unit is labeled with a code designation which includes plant location, date of production, batch number and production line.

PPYMDD TT:TT

<u>P - Plant code</u> -	LD = Cedar Rapids
<u>Y - Year</u> -	1 digit (last digit of year)
<u>M - Month</u> -	1 alpha (see month code key below)
<u>D - Day of Month</u> -	2 digits
<u>B - Batch Identifier</u> -	3 digits and 1 alpha
<u>T - Military Time</u> -	4 digits w/ colon

Example: For product packed at Cedar Rapids on 07/27/2013 at 2:30 PM would read:

LD 3G27 14:30

Month Code Key (Note: the letter "I" is not used)

A = January	G = July
B = February	H = August
C = March	J = September
D = April	K = October
E = May	L = November
F = June	M = December

STORAGE: *Keep frozen at or below 0°F*

SHELF LIFE: *730 days*



INGREDIENT STATEMENT:

WATER, COOKED EGG NOODLES (WATER, ENRICHED FLOUR [WHEAT FLOUR, NIACIN, IRON, THIAMINE MONONITRATE, RIBOFLAVIN, FOLIC ACID], EGGS), COOKED CHICKEN MEAT (WHITE MEAT CHICKEN, DARK MEAT CHICKEN, WATER, MODIFIED POTATO STARCH, SALT, SODIUM PHOSPHATE, CARRAGEENAN), CARROTS, CELERY, CONTAINS 2% OR LESS OF: MODIFIED CORNSTARCH, SALT, CHICKEN FLAVOR (SALT, HYDROLYZED CORN GLUTEN, SUGAR, YEAST EXTRACT, CHICKEN POWDER, YEAST, ROSEMARY, SOY FLOUR), RENDERED CHICKEN FAT (CHICKEN FAT, NATURAL FLAVORING), CHICKEN SEASONING (AUTOLYZED YEAST EXTRACT, CHICKEN FAT, TAPIOCA DEXTRIN, CORN MALTODEXTRIN, HYDROLYZED WHEAT PROTEIN, FLAVOR, MODIFIED CORNSTARCH, CARAMEL COLOR, GRILL FLAVOR [FROM VEGETABLE OIL], DISODIUM GUANYLATE, DISODIUM INOSINATE, TRICALCIUM PHOSPHATE, LACTIC ACID), ENRICHED FLOUR (WHEAT FLOUR, NIACIN, REDUCED IRON, THIAMINE MONONITRATE, RIBOFLAVIN, FOLIC ACID), DEHYDRATED ONIONS, YEAST EXTRACT (CONTAINS SOYBEAN OIL), CHICKEN BROTH POWDER (CHICKEN BROTH, SALT, FLAVORINGS), SUGAR, MONO – AND DIGLYCERIDES (SOY), PARSLEY, WHITE PEPPER, YELLOW #5.

ALLERGENS: EGGS, SOYBEANS, WHEAT

NUTRITIONAL DATA:

Per Serving

Per 100 gram

Nutrition Facts	
Serving Size 1 cup (245g)	
Servings Per Container About 59	
Amount Per Serving	
Calories 100	Calories from Fat 25
% Daily Value*	
Total Fat 2.5g	4%
Saturated Fat 1g	5%
Trans Fat 0g	
Cholesterol 25mg	8%
Sodium 900mg	38%
Total Carbohydrate 18g	6%
Dietary Fiber 1g	4%
Sugars 1g	
Protein 5g	
Vitamin A 6%	• Vitamin C 2%
Calcium 2%	• Iron 6%
*Percent Daily Values are based on a 2,000 calorie diet. Your daily values may be higher or lower depending on your calorie needs:	
	Calories: 2,000 2,500
Total Fat	Less than 65g 80g
Saturated Fat	Less than 20g 25g
Cholesterol	Less than 300mg 300 mg
Sodium	Less than 2,400mg 2,400mg
Total Carbohydrate	300g 375g
Dietary Fiber	25g 30g
Calories per gram:	
Fat 9 • Carbohydrate 4 • Protein 4	

Nutrient	Amount Per 100g	
Calories	41.00	kcal
Calories from Fat	9.90	kcal
Total Fat	1.10	g
Saturated Fat	0.33	g
Trans Fat	0.01	g
Ash	1.13	g
Cholesterol	10.77	mg
Sodium	367.63	mg
Potassium	48.60	mg
Total Carbohydrate	7.51	g
Dietary Fiber	0.39	g
Sugars	0.45	g
Protein	2.23	g
Vitamin A	131.28	IU
Vitamin C	0.41	mg
Calcium	8.06	mg
Iron	0.50	mg

NATIONAL SCHOOL LUNCH PROGRAM CHILD NUTRITION MEAL CREDITS: ½ OZ MEAT, 1 GRAIN