



HEINZ

PRODUCT SPECIFICATION SHEET

PRODUCT: GORDON FOOD SERVICE CREAM OF POTATO WITH BACON

VARIETY NUMBER: 131120

PACKAGE SIZE: 4-8 LB BAGS PER CASE

PRODUCT DESCRIPTION: Diced potatoes, sliced onions, tender carrots and crisp celery are cooked in a heavy cream stock that's seasoned with garlic, parsley and savory pieces of real bacon that add a light smokiness.

PREPARATION INSTRUCTIONS*:

Boil-in-Bag:

1. CAREFULLY PLACE UNOPENED BAG OF PRODUCT IN BOILING WATER.
2. COOK UNTIL CONTENTS REACH 185°F.
3. CHECK TEMPERATURE BY REMOVING BAG FROM WATER; FOLD THE UNOPENED BAG AROUND A STEMMED THERMOMETER.
4. TRANSFER COOKED PRODUCT TO HOLDING OR SERVING CONTAINER:
 - a. FOR EASIER HANDLING, INSERT POUCH INTO LARGE PITCHER.
 - b. CUT OPEN CORNER OF POUCH OPPOSITE PITCHER HANDLE.
5. CAREFULLY POUR INTO SERVING CONTAINER; HOLD & SERVE AT GREATER THAN 150°F.

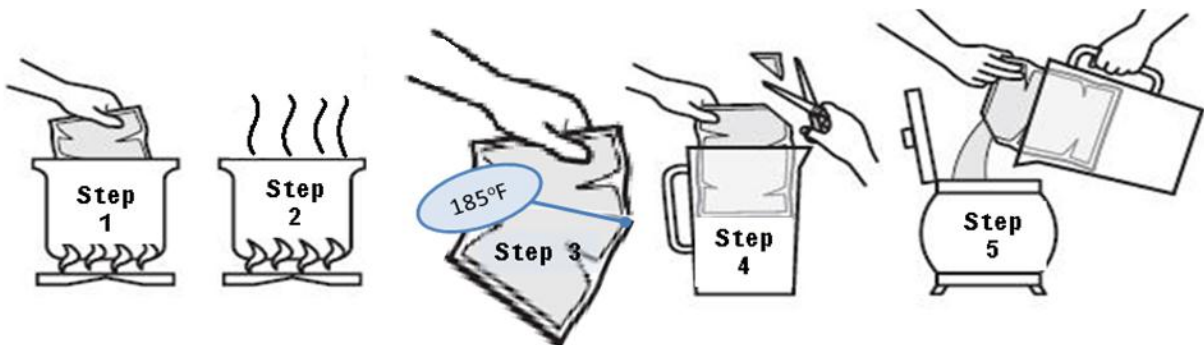

FOLLOW THE FDA FOOD CODE FOR HANDLING LEFTOVERS

ANALYTICAL DATA:

Available Upon Request

MICROBIOLOGICAL DATA:

Available Upon Request



CONTAINER PACKAGING:

Container: 8 lb Bag

CONTAINER CODING: Primary Packaging

PP YM DD BBBB TT:TT (Explanation below)

CASE PACKAGING:

Pack/Size: 4/8 lbs.
Case Net Wt: 32 lbs.
Case Gross Wt: 33.05 lbs.
Case Cube: 0.88 cu ft.
Case Size (OD): 16" x 13.313" x 7.125"
Cases/Pallet: 63
Cases/Layer: 9
Layers/Pallet: 7

CASE CODING: Secondary Packaging

Example: PP YM DD TT:TT (Explanation Below)

CODE DESIGNATION

Each case and unit is labeled with a code designation which includes plant location, date of production, batch number and production line.

PPYMDD TT:TT

- P - Plant code** - LD = Cedar Rapids
- Y - Year** - 1 digit (last digit of year)
- M - Month** - 1 alpha (see month code key below)
- D - Day of Month** - 2 digits
- B - Batch Identifier** - 3 digits and 1 alpha
- T - Military Time** - 4 digits w/ colon

Example: For product packed at Cedar Rapids on 07/27/2013 at 2:30 PM would read:

LD 3G27 14:30

Month Code Key (Note: the letter "I" is not used)

- | | |
|--------------|---------------|
| A = January | G = July |
| B = February | H = August |
| C = March | J = September |
| D = April | K = October |
| E = May | L = November |
| F = June | M = December |

STORAGE: *Keep frozen at or below 0°F*

SHELF LIFE: *730 days*



INGREDIENT STATEMENT:

WATER, DEHYDRATED POTATOES (POTATOES, SODIUM ACID PYROPHOSPHATE), HEAVY CREAM, CARROTS, CELERY, NONFAT DRY MILK, MODIFIED CORNSTARCH, COOKED BACON (BACON [CURED WITH WATER, SALT, SUGAR, SODIUM PHOSPHATES, SODIUM ERYTHORBATE, SODIUM NITRITE], SMOKE FLAVOR), CONTAINS 2% OR LESS OF: SOYBEAN OIL, WHEY POWDER (MILK), DEHYDRATED POTATO FLAKES (POTATOES, MONO- AND DIGLYCERIDES, SODIUM ACID PYROPHOSPHATE, CITRIC ACID), GREEN BELL PEPPERS, RENDERED BACON FLAVORED FAT, SALT, FLAVORING (SALT, MALTODEXTRIN [CORN], SUGAR, HYDROLYZED WHEAT GLUTEN, SOYBEAN OIL, SUNFLOWER OIL, DISODIUM INOSINATE AND DISODIUM GUANYLATE, FLAVORS, YEAST EXTRACT, TURMERIC [COLOR], NATURAL SMOKE FLAVOR, ANNATTO EXTRACT [COLOR]), CREAM FLAVOR (LACTOSE, WHEY PROTEIN CONCENTRATE [MILK], CREAM POWDER [CREAM, NONFAT MILK, SOY LECITHIN], MODIFIED CORNSTARCH, MILK FAT, MANNITOL, XANTHAN GUM, ARTIFICIAL COLOR, SALT, NATURAL FLAVORING), BUTTER FLAVOR (WHEY SOLIDS [MILK], ENZYME MODIFIED BUTTER, CORN MALTODEXTRIN, SALT, DEHYDRATED BUTTER, GUAR GUM, ANNATTO AND TURMERIC), MONO- AND DIGLYCERIDES (SOY), ONIONS, YEAST EXTRACT (CONTAINS SOYBEAN OIL), SUGAR, WHITE PEPPER, PARSLEY, GARLIC POWDER.

ALLERGENS: MILK, SOYBEANS, WHEAT

NUTRITIONAL DATA:

Per Serving

Per 100 gram

Nutrition Facts	
Serving Size 1 cup (245g)	
Servings Per Container About 59	
Amount Per Serving	
Calories 210	Calories from Fat 100
% Daily Value*	
Total Fat 11g	17%
Saturated Fat 5g	25%
Trans Fat 0g	
Cholesterol 25mg	8%
Sodium 910mg	38%
Total Carbohydrate 22g	7%
Dietary Fiber 1g	4%
Sugars 6g	
Protein 6g	
Vitamin A 10%	Vitamin C 30%
Calcium 10%	Iron 4%
*Percent Daily Values are based on a 2,000 calorie diet. Your daily values may be higher or lower depending on your calorie needs:	
	Calories: 2,000 2,500
Total Fat	Less than 65g 80g
Saturated Fat	Less than 20g 25g
Cholesterol	Less than 300mg 300 mg
Sodium	Less than 2,400mg 2,400mg
Total Carbohydrate	300g 375g
Dietary Fiber	25g 30g
Calories per gram:	
Fat 9 • Carbohydrate 4 • Protein 4	

Nutrient	Amount Per 100g	
Calories	84.91	kcal
Calories from Fat	39.24	kcal
Total Fat	4.36	g
Saturated Fat	1.97	g
Trans Fat	0.09	g
Ash	1.49	g
Cholesterol	11.00	mg
Sodium	369.92	mg
Potassium	179.91	mg
Total Carbohydrate	8.91	g
Dietary Fiber	0.53	g
Sugars	2.54	g
Protein	2.35	g
Vitamin A	219.70	IU
Vitamin C	6.84	mg
Calcium	46.95	mg
Iron	0.26	mg

NATIONAL SCHOOL LUNCH PROGRAM CHILD NUTRITION MEAL CREDITS: ½ STARCHY VEGETABLE