



HEINZ

PRODUCT SPECIFICATION SHEET

PRODUCT: TRUESOUPS CHIMICHURRI STEAK & WHITE BEAN

VARIETY NUMBER: 152020

PACKAGE SIZE: 4 – 4 LB BAGS PER CASE

PRODUCT DESCRIPTION: A SOUTH AMERICAN FLAVOR FAVORITE, THIS HEARTY STEAK AND PROTEIN PACKED WHITE BEAN SOUP IS SIMMERED WITH TOMATOES, ONIONS, LEEKS, AND CARROTS, FINISHED WITH TRADITIONAL “CHIMICHURRI” FLAVORS LIKE PARSLEY, CILANTRO, OREGANO, GARLIC, EXTRA VIRGIN OLIVE OIL, AND RED WINE VINEGAR. ¡QUÉ BUENO!

READY TO COOK

PREPARATION INSTRUCTIONS:

Boil-in-Bag:

1. CAREFULLY PLACE UNOPENED BAG OF PRODUCT IN BOILING WATER.
2. COOK UNTIL CONTENTS REACH 185°F.
3. CHECK TEMPERATURE BY REMOVING BAG FROM WATER; FOLD THE UNOPENED BAG AROUND A STEMMED THERMOMETER.
4. TRANSFER COOKED PRODUCT TO HOLDING OR SERVING CONTAINER:
 - a. FOR EASIER HANDLING, INSERT POUCH INTO LARGE PITCHER.
 - b. CUT OPEN CORNER OF POUCH OPPOSITE PITCHER HANDLE.
5. CAREFULLY POUR INTO SERVING CONTAINER; HOLD & SERVE AT GREATER THAN 150°F.

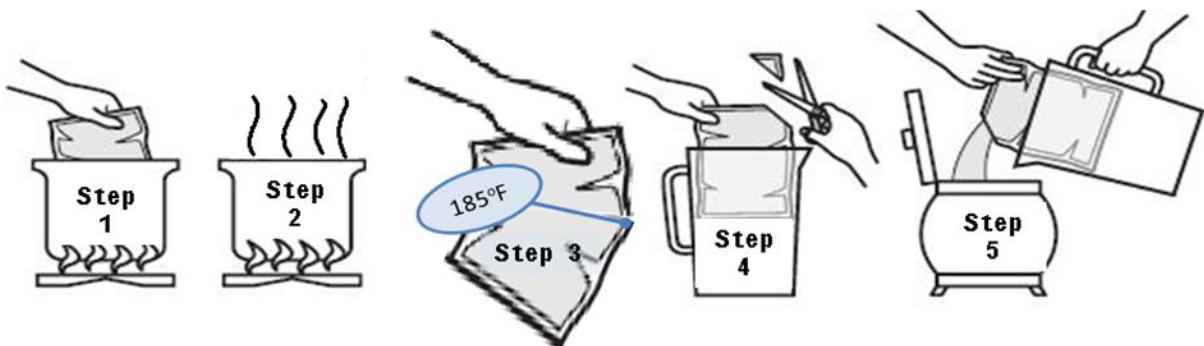

FOLLOW THE FDA FOOD CODE FOR HANDLING LEFTOVERS.

ANALYTICAL DATA: Available Upon Request

MICROBIOLOGICAL DATA: Available Upon Request



CONTAINER PACKAGING:

Container: 4 lb Bag

CONTAINER CODING: Primary Packaging

PP YM DD BBBB TT:TT (Explanation below)

CASE PACKAGING:

Pack/Size: 4/4 lbs.
Case Net Wt: 16.0 lbs.
Case Gross Wt: 17.0 lbs.
Case Cube: .47
Case Size (OD): 11.625" x 9.375" x 7.5"
Cases/Pallet: 119
Cases/Layer: 17
Layers/Pallet: 7

CASE CODING: Secondary Packaging

Example: PP YM DD TT:TT (Explanation Below)

CODE DESIGNATION

Each case and unit is labeled with a code designation which includes plant location, date of production, batch number and production line.

PPYMDD TT:TT

- | | |
|--------------------------------------|------------------------------------|
| <u>P - Plant code</u> - | LD = Cedar Rapids |
| <u>Y - Year</u> - | 1 digit (last digit of year) |
| <u>M - Month</u> - | 1 alpha (see month code key below) |
| <u>D - Day of Month</u> - | 2 digits |
| <u>B - Batch Identifier</u> - | 3 digits and 1 alpha |
| <u>T - Military Time</u> - | 4 digits w/ colon |

Example: For product packed at Cedar Rapids on 07/27/2011 at 2:30 PM would read:

LD 1G27 14:30

Month Code Key (Note: the letter "I" is not used)

- | | |
|--------------|---------------|
| A = January | G = July |
| B = February | H = August |
| C = March | J = September |
| D = April | K = October |
| E = May | L = November |
| F = June | M = December |

MANUFACTURING LOCATION: CEDAR RAPIDS, IOWA, P15818A, M15818A

STORAGE: Keep frozen at or below 0°F

DISTRIBUTION: Keep frozen

SHELF LIFE: 720 days



INGREDIENT STATEMENT:

WATER, COOKED NAVY BEANS, DICED TOMATOES IN JUICE (TOMATOES, TOMATO JUICE, CITRIC ACID, CALCIUM CHLORIDE), COOKED BEEF STEAK DICES AND MODIFIED FOOD STARCH PRODUCT WITH CARAMEL COLOR ADDED (BEEF, WATER, DEXTROSE, SALT, MODIFIED CORNSTARCH, CONCENTRATED BEEF STOCK, SODIUM PHOSPHATES, BEEF TALLOW, CARAMEL COLOR, SPICE EXTRACTIVES), ONIONS, CARROTS, CARROT PUREE, CELERY, CABBAGE, CONTAINS 2% OR LESS OF: LEEKS, OLIVE OIL, CHOPPED GARLIC (WATER, GARLIC, PHOSPHORIC ACID, POTASSIUM SORBATE, XANTHAN GUM, GUAR GUM), POMACE OLIVE OIL, SALT, COOKED CHICKEN MEAT, SPICES, PARSLEY, RED WINE VINEGAR (CONTAINS WATER AND SULPHUR DIOXIDE), RENDERED CHICKEN FAT (CHICKEN FAT, NATURAL FLAVORINGS), SUGAR, XANTHAN GUM, WHEY POWDER (MILK), ONION POWDER, BLACK PEPPER.

ALLERGENS: MILK

NUTRITIONAL DATA:

Per Serving

Per 100 gram

Nutrition Facts	
Serving Size 1 cup (245g)	
Servings Per Container About 30	
Amount Per Serving	
Calories 200	Calories from Fat 80
<small>% Daily Value*</small>	
Total Fat 9g	14%
Saturated Fat 2g	10%
Trans Fat 0g	
Cholesterol 25mg	8%
Sodium 990mg	41%
Total Carbohydrate 17g	6%
Dietary Fiber 7g	28%
Sugars 4g	
Protein 11g	
Vitamin A 35%	• Vitamin C 15%
Calcium 10%	• Iron 15%
<small>*Percent Daily Values are based on a 2,000 calorie diet. Your daily values may be higher or lower depending on your calorie needs:</small>	
	<small>Calories: 2,000 2,500</small>
Total Fat	Less than 65g 80g
Saturated Fat	Less than 20g 25g
Cholesterol	Less than 300mg 300 mg
Sodium	Less than 2,400mg 2,400mg
Total Carbohydrate	300g 375g
Dietary Fiber	25g 30g
<small>Calories per gram:</small>	
Fat 9 • Carbohydrate 4 • Protein 4	

Nutrient	Amount Per 100g	
Calories	80.18	kcal
Calories from Fat	34.20	kcal
Total Fat	3.80	g
Saturated Fat	0.75	g
Trans Fat	0.00	g
Ash	1.58	g
Cholesterol	10.58	mg
Sodium	404.92	mg
Potassium	193.32	mg
Total Carbohydrate	6.87	g
Dietary Fiber	2.89	g
Sugars	1.55	g
Protein	4.50	g
Vitamin A	744.80	IU
Vitamin C	3.09	mg
Calcium	41.07	mg
Iron	1.25	mg